

MAXIMUM FACE RUNOUT TO BE .004 T.I.R.  
 MAXIMUM PILOT ECCENTRICITY TO BE .004 T.I.R.  
 PERMISSIBLE SHAFT RUNOUT TO BE .002 T.I.R.  
 ALIGN BASE TO C-FACE MOUNTING HOLES ±1/16"

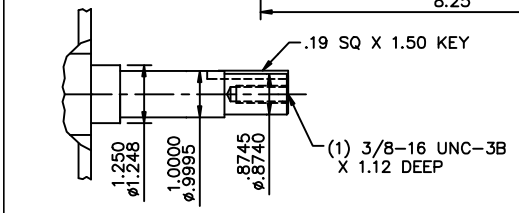

DASH NO.	"C"	"AD"
1100	17.38	5.50
1150	17.88	6.00
1200	18.38	6.50
1250	18.88	7.00
1300	19.38	7.50
1350	19.88	8.00
1400	20.38	8.50

REVISION		BY & DATE	CHK	ANG	±1/2'	FINISH	CAD FILE	037603	SIZE	DRAWING NO.	REV.
01	UPDATED PER MT2 CONVERSION	LST 5/28/10							B	037603	01
TOLERANCES UNLESS SPECIFIED DEC. INCHES .X ±.1 .XX ±.03 .XXX ±.005 .XXXX ±.0005 RFP DIST NLV											
LEESON ELECTRIC MOTORS GEARMOTORS AND DRIVES TITLE OUTLINE - 210JM FRAME DRIP PROOF - RIGID "C" MAT'L JM PUMP						DRAWN MGM 10/28/02 CHK APPD SCALE 3=8 REF OL140666 FMF PREV					
THIS DRAWING IN DESIGN AND DETAIL IS OUR PROPERTY AND MUST NOT BE USED EXCEPT IN CONNECTION WITH OUR WORK ALL RIGHTS OF DESIGN AND INVENTION ARE RESERVED THIS IS AN ELECTRONICALLY GENERATED DOCUMENT - DO NOT SCALE THIS PRINT											