

- * NOTE:
 1. 2.080 PRESS IN IS ONLY USED FOR 2 POLE 1Ø MOTORS WHEN STACK IS AT THE MAX. FOR FRAME LENGTH.
 2. WHEN 2.080 PRESS IN IS USED, COMPONENT PLATE FOR CAPACITORS CAN NOT BE USED IN THE SHAFT END BRACKET.

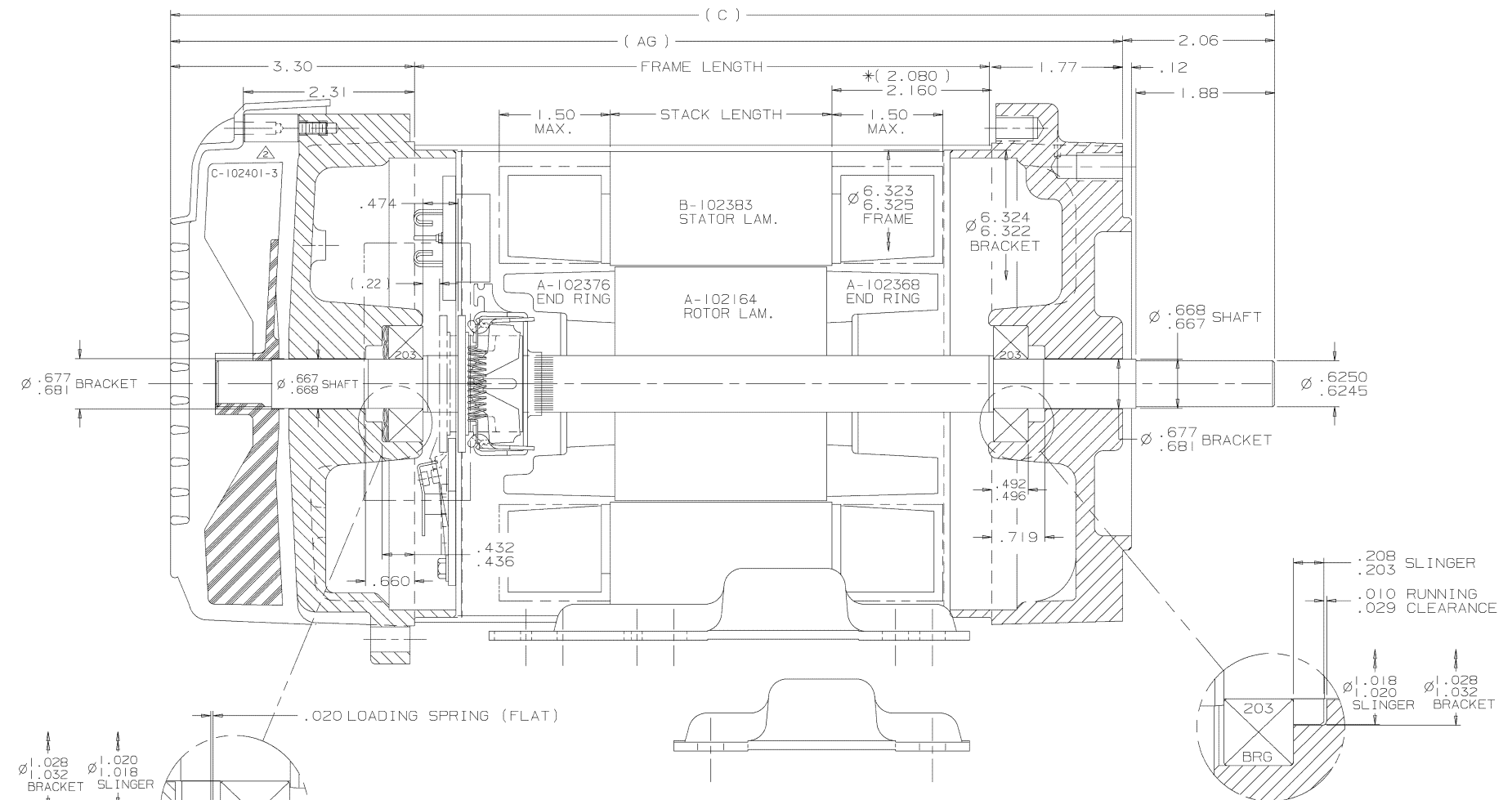

DASH	FRAME LENGTH	MAX. STACK	AG	C
631	6.31	1.50	11.38	13.44
681	6.81	2.00	11.88	13.94
731	7.31	2.50	12.38	14.44
781	7.81	3.00	12.88	14.94
831	8.31	3.50	13.38	15.44
881	8.81	4.00	13.88	15.94
931	9.31	4.50	14.38	16.44
981	9.81	5.00	14.88	16.94

REV	DATE	CHANGE	NAME	PART NAME	LAYOUT-203 BRG. BOTH ENDS	DRWG NO
4		6.324/6.322 TOL. WAS 6.323/6.322 CN18429	KL	56 FR. -EXP. PR. -TEFC -C'FACE		C-L06420C
3	12-13-94	ADDED 2.080 PRESS IN & SPL. NOTE	KL			
2	12-09-94	UPDATED FRONT BRACKET PER ACTUAL PART-ADDED STANDOFF CN19060	KL			