

M1040689.00

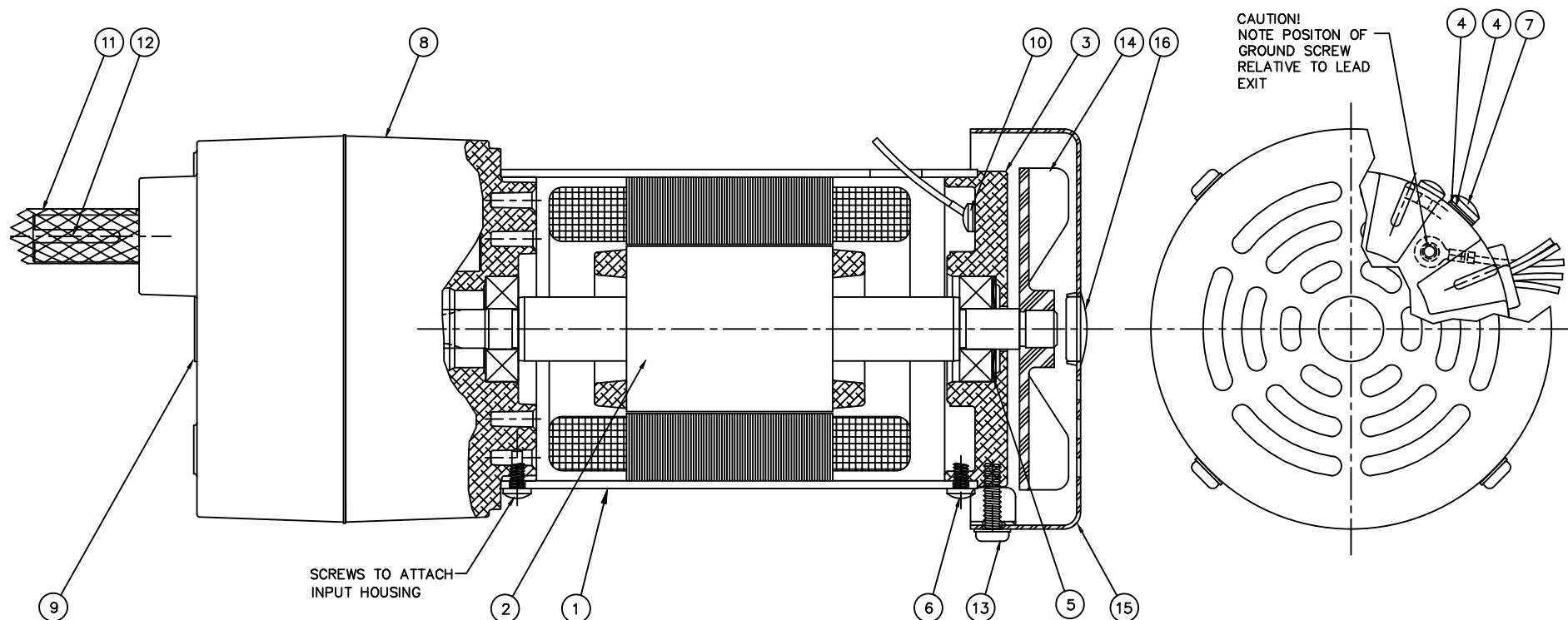

16	HOLE PLUG
15	FAN SHROUD
14	FAN
13	TFS 8-32 X .63 PP ZP
12	.125 X .125 X .75 LONG KEY
11	PLASTIC MESH
10	6-32 X .25 PP ZP
9	PIPE PLUG
8	PZ GEAR BOX
7	TFS 8-32 X .25 PP ZP
6	TFS 6-32 X .38 PP ZP
5	WAVY SPRING
4	FLAT WASHER
3	ENDBELL MACHINED
2	ROTOR SHAFT ASSEMBLY
1	FRAME STATOR ASSEMBLY
BALLOON	DESCRIPTION

NOTE
1) SHIP CAPACITOR LOOSE WITH MOTOR

						TOLERANCES UNLESS OTHERWISE SPECIFIED				LEESON ELECTRIC CORPORATION			
						DECIMALS							
						.00	± .01	DRAWN SAD 10/21/97	TITLE GENERAL ASSEMBLY 31 FR. AC PZ GEARMOTOR				
						.000	± .005	CHK'D.					
						.0000	± .0005	APPR.	MAT'L.				
NO.	REVISION			BY	DATE	FRACTIONS	± 1/64	SCALE 1=1	FINISH				
THIS DRAWING IN DESIGN AND DETAIL IS OUR PROPERTY AND MUST NOT BE USED EXCEPT IN CONNECTION WITH OUR WORK ALL RIGHTS OF DESIGN AND INVENTION ARE RESERVED						ANGLES	± 1/2"	REF. M1040366.00					
						INCH/MM		FMF	STOCK		SIZE B	DRAWING NO. M1040689.00	