

WLS28 Work Light Strip

WLS28 Work Light Strip

General-Purpose LED Work Light Strip



- High power solid state LED array with cool white light
- Designed for enclosure or area lighting
- Rugged aluminum housing
- Narrow 28 mm total width
- Lighted lengths available from 145 mm to 1130 mm
- Low-profile design with included swivel mounting brackets
- Illuminates a large area with an even pattern of light and no shadows
- 12 to 30V dc operation
- Cabled and Quick Disconnect models available
- Stand-alone and cascadable models available
- ON/OFF switch and non-switch models available
- Low power consumption; less than 9 watts per foot



NOTE: When cascading lights, a model with an ON/OFF switch can be used to control the lights cascaded off of the switched model.

Work Light Strip Models

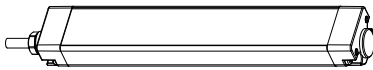

Stand-Alone Light—cable

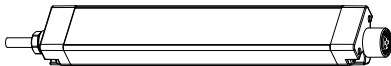

First Light in a Cascade—cable

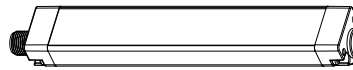

Stand-Alone Light or End Light in a Cascade—QD

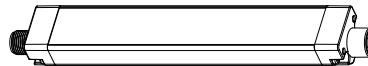

First or Middle of a Cascade—QD

WLS28 Work Light Strips are available as either stand-alone models, or as cascade models that can be "daisy-chained" together for a continuous length of lighting, with a minimum of wiring.

Stand-alone models have cable or male QD fitting at one end for power connection, no connections at opposite end. A stand-alone model may be used as the last in the cascade series.

Cascade models have cable or male QD fitting at one end for power connection, female QD fitting at opposite end for connection to other lights in the cascade. Cascade models with cable end can only be used as the first light in the cascade series. A double-ended accessory cordset (see [Cordsets](#) on page 5) must be used between each pair of lights in a cascade.



Table 1: Non-Switch Models

Models		Lighted Length	Power Connector*
Stand-Alone	Cascade		
WLS28XW145X	WLS28CW145X	145 mm	2 m cable
WLS28XW285X	WLS28CW285X	285 mm	
WLS28XW430X	WLS28CW430X	430 mm	
WLS28XW570X	WLS28CW570X	570 mm	
WLS28XW710X	WLS28CW710X	710 mm	
WLS28XW850X	WLS28CW850X	850 mm	
WLS28XW990X	WLS28CW990X	990 mm	
WLS28XW1130X	WLS28CW1130X	1130 mm	

*Only cabled power connector models are listed. For 4-pin M12/Euro-style integral power connector, add suffix **Q** to the model number (for example, **WLS28XW285XQ**).

Table 2: ON/OFF Switch Models

Models		Lighted Length	Power Connector*
Stand-Alone	Cascade		
WLS28XW145XPB	WLS28CW145XPB	145 mm	2 m cable
WLS28XW285XPB	WLS28CW285XPB	285 mm	
WLS28XW430XPB	WLS28CW430XPB	430 mm	
WLS28XW570XPB	WLS28CW570XPB	570 mm	
WLS28XW710XPB	WLS28CW710XPB	710 mm	
WLS28XW850XPB	WLS28CW850XPB	850 mm	
WLS28XW990XPB	WLS28CW990XPB	990 mm	
WLS28XW1130XPB	WLS28CW1130XPB	1130 mm	

*Only cabled power connector models are listed. For 4-pin M12/Euro-style integral power connector, add suffix **Q** to the model number (for example, **WLS28XW285XPBQ**).

Specifications

Supply Voltage and Current

12 to 30V dc (10% max. ripple)

Use only with suitable Class 2 power supply.

Max current per length:

Light Length	12V dc	24V dc	30V dc	Watts	Lumens (Typical @ 25° C)
145 mm	0.5A	0.25A	0.2A	6	140
285 mm	0.75A	0.375A	0.3A	9	280
430 mm	1.25A	0.625A	0.5A	15	420
570 mm	1.5A	0.75A	0.6A	18	560
710 mm	2.0A	1.0A	0.8A	24	700
850 mm	2.25A	1.125A	0.9A	27	840
990 mm	2.75A	1.375A	1.1A	33	980
1130 mm	3.0A	1.5A	1.2A	36	1120

Light Characteristics

Color Temperature (CCT): 5000 - 8300K

Color: Cool White

Useful Life

When operating within specifications, output will decrease less than 30% after 50,000 hours.

Construction

Clear anodized aluminum housing; black painted zinc end caps; clear acrylic window; zinc plated steel brackets

Mounting

(2) swivel brackets and (4) screws included

Environmental Rating

IP50

Connections

Integral 4-pin Euro style QD, or 2 m (6.5') integral cable

Operating Temperature

-20° to +50° C (-4° to +122° F)

Storage Temperature

-40° to +70° C (-40° to +158° F)

Certifications



Non-switch models only. Certification pending for models with an ON/OFF switch (PB)

Application Notes

When connecting cascable lights in series it is important not to exceed maximum current limitations:

Maximum length of light at 12V dc: 1.5 m

Maximum length of light at 24V dc: 3.0 m

Maximum length of light at 30V dc: 3.1 m

Dimensions

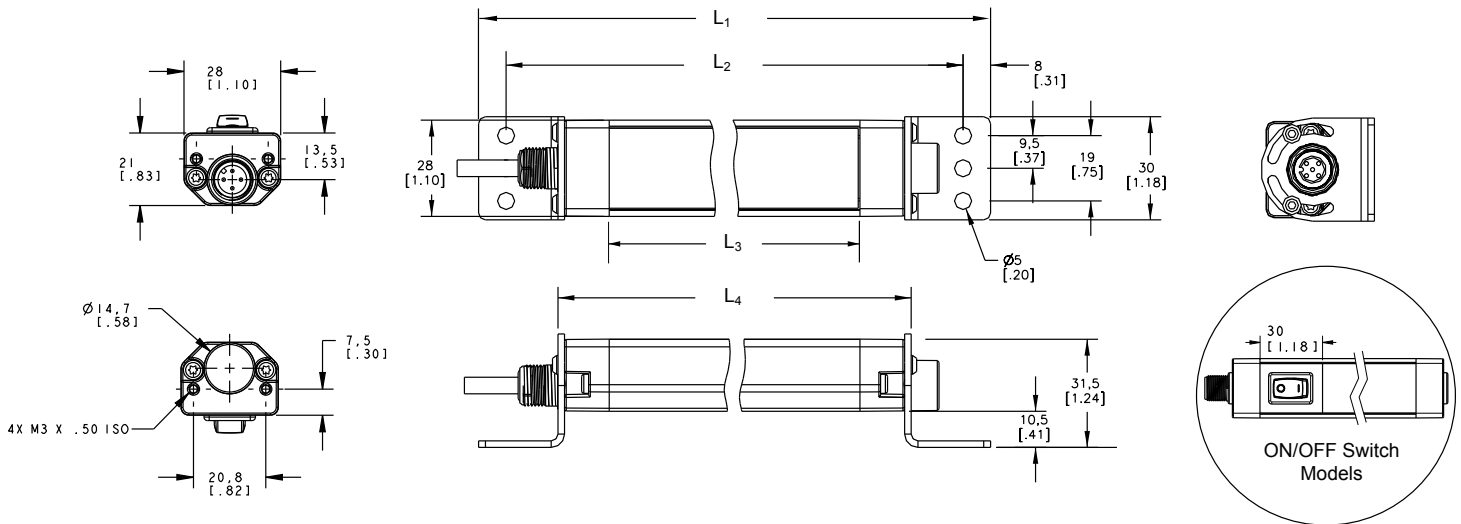

Non-Switch Models				
Model	L ₁	L ₂	L ₃	L ₄
WLS28..W145X..	221 mm (8.7")	205 mm (8.1")	145 mm (5.71")	175 mm (6.9")
WLS28..W285X..	362 mm (14.3")	346 mm (13.6")	286 mm (11.26")	316 mm (12.4")
WLS28..W430X..	503 mm (19.8")	487 mm (19.2")	427 mm (16.81")	457 mm (18.0")
WLS28..W570X..	644 mm (25.4")	628 mm (24.7")	568 mm (22.36")	598 mm (23.5")
WLS28..W710X..	785 mm (30.9")	769 mm (30.3")	709 mm (27.91")	739 mm (29.1")
WLS28..W850X..	926 mm (36.5")	910 mm (35.8")	850 mm (33.46")	880 mm (34.6")
WLS28..W990X..	1067 mm (42")	1051 mm (41.4")	991 mm (39.02")	1021 mm (40.2")
WLS28..W1130X..	1208 mm (47.6")	1192 mm (46.9")	1132 mm (44.57")	1162 mm (45.7")

ON/OFF Switch Models				
Model	L ₁	L ₂	L ₃	L ₄
WLS28..W145XPB..	251 mm (9.9")	235 mm (9.3")	145 mm (5.71")	205 mm (8.1")
WLS28..W285XPB..	392 mm (15.4")	376 mm (14.8")	286 mm (11.26")	346 mm (13.6")
WLS28..W430XPB..	533 mm (21.0")	517 mm (20.4")	427 mm (16.81")	487 mm (19.2")
WLS28..W570XPB..	674 mm (26.5")	658 mm (25.9")	568 mm (22.36")	628 mm (24.7")
WLS28..W710XPB..	815 mm (32.1")	799 mm (31.5")	709 mm (27.91")	769 mm (30.3")
WLS28..W850XPB..	956 mm (37.6")	940 mm (37")	850 mm (33.46")	910 mm (35.8")
WLS28..W990XPB..	1097 mm (43.2")	1081 mm (42.6")	991 mm (39.02")	1051 mm (41.4")
WLS28..W1130XPB..	1238 mm (48.7")	1222 mm (48.1")	1132 mm (44.57")	1192 mm (46.9")

Wiring

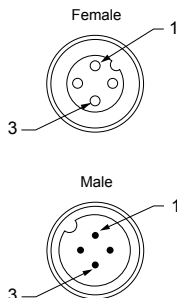
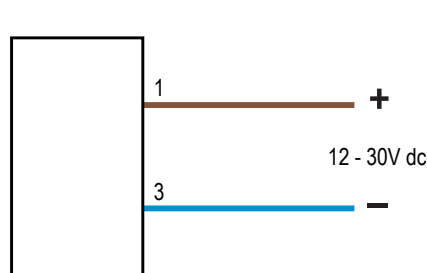

Wiring Key:

- 1 = Brown
- 3 = Blue

Accessories

Replacement Bracket and Unistrut Mounting Hardware

SMBWLS28RA

The bracket kit is available as a replacement for the one that comes with the Work Light Strip. Kit contains 2 end brackets, 4 screws.



SMH1316

This kit allows the light be mounted to a 13/16" Uni-strut channel. The kit includes:

- 2 X 10-32 spring nuts
- 2 X 10-32 socket head cap screws
- 2 X #10 lock washers

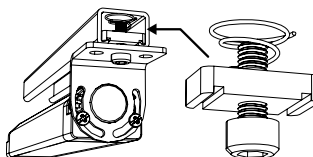

Cordsets

Single-ended cordsets are for use between power source and QD connection of stand-alone light or first light in a cascade.
Double-ended cordsets are for use between lights in a cascade.

Single-Ended Cordsets

4-Pin M12/Euro-Style Cordsets (straight connector)

- MQDC-406, 2 m (6.5')
- MQDC-415, 5 m (15')
- MQDC-430, 9 m (30')

4-Pin M12/Euro-Style Cordsets (right-angle connector)

- MQDC-406RA, 2 m (6.5')
- MQDC-415RA, 5 m (15')
- MQDC-430RA, 9 m (30')

Double-Ended Cordsets

4-Pin M12/Euro-Style Cordsets — Double-Ended (straight male/straight female connectors)

- MQDEC-401SS, 0.3 m (1')
- MQDEC-403SS, 1 m (3')
- MQDEC-406SS, 2 m (6.5')
- MQDEC-412SS, 4 m (12')
- MQDEC-420SS, 7 m (23')
- MQDEC-430SS, 10 m (33')
- MQDEC-450SS, 15 m (50')

Splitter Cordsets

4-Pin M12/Euro-Style Cordsets — Splitter

CSB-M1240M1240, 10 mm (0.4") male trunk; 2 x 10 mm (0.4") female branches

CSB-M1241M1241, 0.3 m (1') male trunk; 2 x 0.3 m (1') female branches

CSB-M1248M1241, 2.5 m (8') male trunk; 2 x 0.3 m (1') female branches

CSB-M12415M1241, 5 m (15') male trunk; 2 x 0.3 m (1') female branches

CSB-M12425M1241, 8 m (26') male trunk; 2 x 0.3 m (1') female branches

CSB-UNT425M1241, 8 m (26') unterminated trunk; 2 x 0.3 m (1') female branches

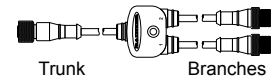

Contact Us

For more information: Contact your local Banner representative or Banner Corporate Offices around the world.

Corporate Headquarters: Banner Engineering Corp. 9714 Tenth Ave. North, Mpls., MN 55441, Tel: 763-544-3164, www.bannerengineering.com, sensors@bannerengineering.com

Europe: Banner Engineering Europe Park Lane, Culliganlaan 2F, Diegem B-1831 BELGIUM, Tel: 32-2 456 07 80, Fax: 32-2 456 07 89, www.bannereurope.com, mail@bannereurope.com

Latin America: Contact Banner Engineering Corp. (US) or e-mail **Mexico:** mexico@bannerengineering.com; or **Brazil:** brasil@bannerengineering.com

Asia:

Banner Engineering China Shanghai Rep Office Rm. G/H/I, 28th Flr. Cross Region Plaza No. 899, Lingling Road, Shanghai 200030 CHINA, Tel: 86-21-54894500, Fax: 86-21-54894511, www.bannerengineering.com.cn, sensors@bannerengineering.com.cn

Banner Engineering Japan Cent-Urban Building 305 3-23-15, Nishi-Nakajima Yodogawa-Ku, Osaka 532-0011 JAPAN, Tel: 81-6-6309-0411, Fax: 81-6-6309-0416, www.bannerengineering.co.jp, mail@bannerengineering.co.jp

Banner Engineering Asia — Taiwan Neihu Technology Park 5F-1, No. 51, Lane 35, Jihu Rd., Taipei 114 TAIWAN, Tel: 886-2-8751-9966, Fax: 886-2-8751-2966, www.bannerengineering.com.tw, info@bannerengineering.com.tw

Banner Engineering India Pune Head Quarters Office, No. 1001 Sai Capital, Opp. ICC Senapati Bapat Road, Pune 411016 INDIA, Tel: 91-20-66405624, Fax: 91-20-66405623, www.bannerengineering.co.in, india@bannerengineering.com



Warranty: Banner Engineering Corporation warrants its products to be free from defects for a period of one year. Banner Engineering Corporation will repair or replace, free of charge, any product of its manufacture found to be defective at the time it is returned to the factory during the warranty period. This warranty does not cover damage or liability for the improper application of Banner products. This warranty is in lieu of any other warranty either expressed or implied.