

O300

The ONE in the INCH class.



O300 – The ONE in the INCH class.

The name Baumer has always stood for consistent innovation. The new O300 optical sensor is following this tradition. This compact, one-inch dimension sensor is ideally suited for systems where space is at a premium. In this category, the O300 offers a performance range that is second to none. This technical advantage adds value to your applications and excellent performance at the best price.

Your benefits:

- Extensive flexibility due to greatest range in its class
- Highly compatible as a result of its one-inch mounting hole spacing and *OneBox* Design (uniform housing design within the product series)
- Maximum operational reliability due to increased excess gain
- Smooth operation under the most difficult conditions thanks to its ambient light immunity and color-independent operation.
- Universal mounting capability easy installation
- Easy design-in thanks to the aligned light beam
- Increased reliability by fully sealed, robust housing

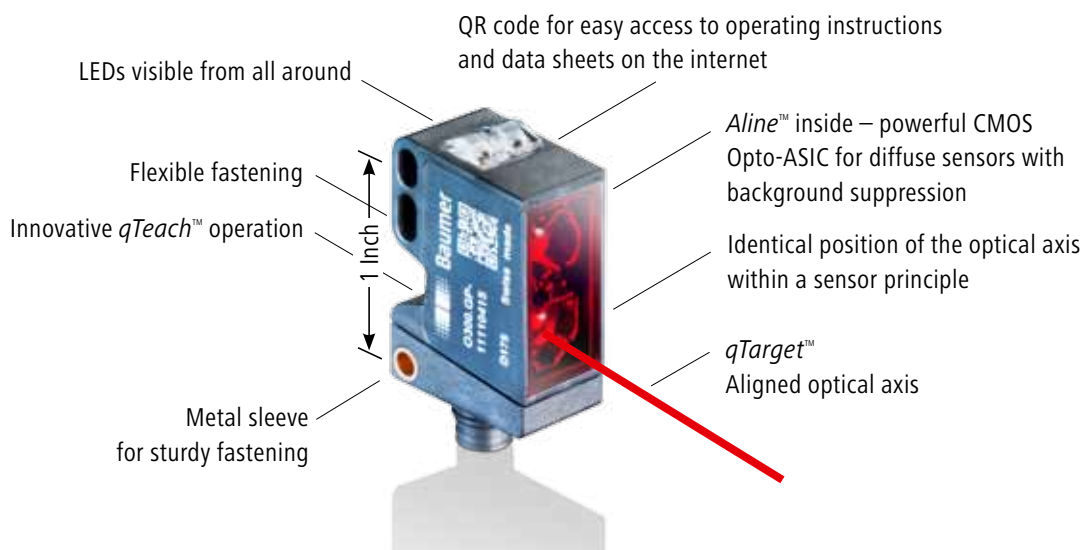

Maximum safety and comfort, minimum operating costs.



Baumer *qTeach™* – easy-to-operate, safe and wear-free

With *qTeach™* we are introducing a new, convenient and wear-free teach procedure. Teaching of O500 sensors is just by a touch with any ferromagnetic tool. A blue LED light provides clear optical feedback. To prevent user errors, *qTeach™* locks autonomously after 5 minutes.



Baumer *qTarget™* – Time-saving installation

The Baumer design aligns the sensor's light beam to the fixing holes. This will not only compensate tolerances between individual components but ensures consistent alignment accuracy within the complete sensor series.

Solutions for demanding applications.

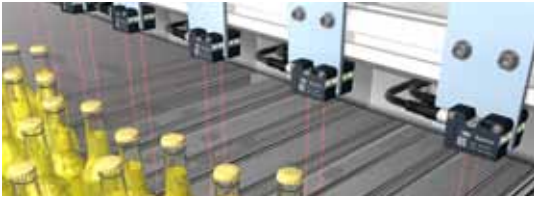

Cascading*

- Prevents mutual interference of sensors positioned next to each other
- Reliable object detection in the most confined spaces

* Applies to *SmartReflect*™ and background suppressor

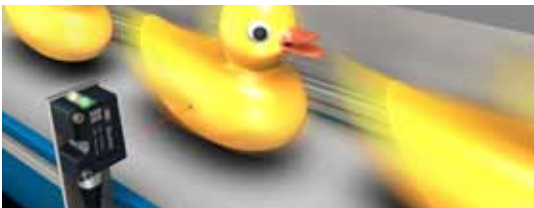

Fast

- Reliable thanks to fast operation
- All technologies feature a short response time of 0,5 ms

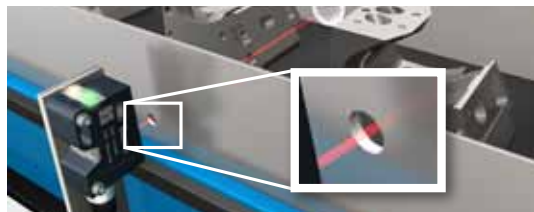

Keyhole Optic*

- Consistently high excess gain even at close range
- Reliable detection at close range

* Applies to retro-reflective sensor

SmartReflect™ – the light barrier without a reflector.

The star in sensor technology

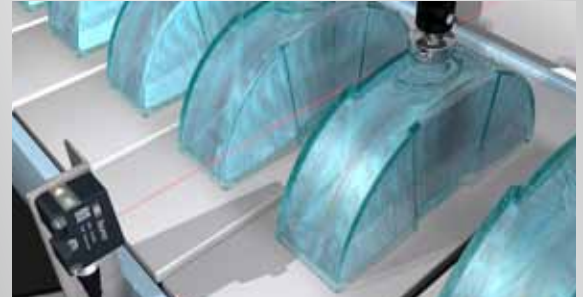

O300 sensor is available with varied sensing principles, such as a retro-reflective or diffuse sensor with background suppressor – and also with *SmartReflect*™ technique.

Thanks to this outstanding

Baumer technology, awarded by Frost & Sullivan, there is no more need for a reflector in object detection which will significantly cut down on costs.

- No separate receiver/reflector required
- Highly reliable object detection thanks to the barrier principle

Your benefit:

No downtimes as a result of dirty or defective reflectors.

Light sources – for every application.

	Light source	Diffuse sensor with background suppression	Retro-reflective sensor	<i>SmartReflect</i> ™ Light barrier
Standard LED: The diffuse light spot is especially suited for object detection during parts feeding.		 30–300 mm	 0–4000 mm	
Baumer <i>PinPoint</i> LED: A small, homogenous light spot with a sharp focus makes <i>PinPoint</i> ideal for exact positioning and detection of small parts.		 30–200 mm	 0–5000 mm	 0–300 mm

Product overview O300

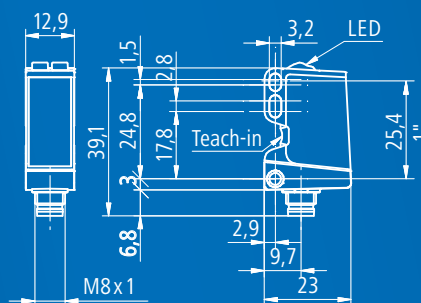

Sensor principle	Light source	Range	Output function	Connection	External teach	Order code*
Diffuse sensor with background suppression	Standard LED	300 mm	Push-Pull	M8, 4-pin		O300.GR-11110414
Diffuse sensor with background suppression	Baumer <i>PinPoint</i> LED	200 mm	Push-Pull	M8, 4-pin	Yes	O300.GP-11110415
Retro-reflective sensor	Standard LED	4000 mm	Push-Pull	M8, 4-pin		O300.RR-11110443
Retro-reflective sensor	Baumer <i>PinPoint</i> LED	5000 mm	Push-Pull	M8, 4-pin	Yes	O300.RP-11110449
<i>SmartReflect</i> Light barrier	Baumer <i>PinPoint</i> LED	300 mm	Push-Pull	M8, 4-pin	Yes	O300.SP-11110450

All types also available with PNP/NPN outputs

Accessories



Mounting bracket L design



M8 connector and plug, straight (ESG 32AH) and angular (ESW 31AH)



Mounting bracket Sensofix

* For installation and connection accessories go to: www.baumer.com/accessories



For more information on the new performance categories in compact optical sensor technology visit: www.baumer.com/O300

Find your local partners at: www.baumer.com/worldwide

Baumer
Passion for Sensors

Baumer Group
International Sales
P.O. Box · Hummelstrasse 17 · CH-8501 Frauenfeld
Phone +41 (0)52 728 1122 · Fax +41 (0)52 728 1144
sales@baumer.com · www.baumer.com