

**Dalton Gear Company**

212 Colfax Ave. N.

Minneapolis, MN 55405 US

**Phone:** 612-374-2150 • **Fax:** 612-374-2467**E-Mail:** daltongear@worldnet.att.net**Dalton Model "OSDC" Overload Safety Device Coupling**

The Dalton OSDC (Overload Safety Device Coupling) provides overload protection through the use of an OSD unit combined with a roller chain coupling half counterbored to fit the OSD flange. Standard double-width roller chain is used to couple the basic OSD unit and the coupling half.

The OSDC can be set with a torque wrench for maximum load desired. The unit functions as a roller chain coupling until an overload occurs, causing the OSDC to disengage. The device is automatically re-engaged when the overload is eliminated.

FORMULA FOR TORQUE-HORSEPOWER (Foot Pounds)

TORQUE (Foot. Pounds) = (HPx5252)/RPM

HORSEPOWER = (Torque x RPM)/525

In furnishing a coupling half to be used in the "OSDC", care must be taken that a standard cut tooth sprocket is not used. The teeth of the "OSDC" coupling half are cut with a special tooth form to compensate for shaft misalignment.

**Important Note:**

The "OSDC" overload safety device can be made to suit your application. Send us your blueprints or specifications, for recommendations by our engineering department.

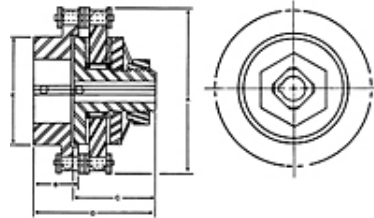

Item #	Maximum Torque	OSD Half	Coupling Half	D - Overall Length	List Price
OSDC-131-1/4x1/4	6 lbs 1 mkp	1/4 Inch 6.4 mm	1/4 Inch 6.4 mm	2 3/8 Inch 60 mm	\$146.00
OSDC-131-1/4x5/16	6 lbs 1 mkp	1/4 Inch 6.4 mm	5/16 Inch 8 mm	2 3/8 Inch 60 mm	\$146.00
OSDC-131-1/4x3/8	6 lbs 1 mkp	1/4 Inch 6.4 mm	3/8 Inch 9.6 mm	2 3/8 Inch 60 mm	\$146.00
OSDC-131-1/4x1/2	6 lbs 1 mkp	1/4 Inch 6.4 mm	1/2 Inch 12.7 mm	2 3/8 Inch 60 mm	\$146.00
OSDC-131-1/4x3/4	6 lbs 1 mkp	1/4 Inch 6.4 mm	3/4 Inch 19.1 mm	2 3/8 Inch 60 mm	\$146.00
OSDC-131-5/16x1/4	6 lbs 1 mkp	5/16 Inch 8 mm	1/4 Inch 6.4 mm	2 3/8 Inch 60 mm	\$146.00
OSDC-131-5/16x5/16	6 lbs 1 mkp	5/16 Inch 8 mm	5/16 Inch 8 mm	2 3/8 Inch 60 mm	\$146.00
OSDC-131-5/16x3/8	6 lbs 1 mkp	5/16 Inch 8 mm	3/8 Inch 9.6 mm	2 3/8 Inch 60 mm	\$146.00
OSDC-131-5/16x1/2	6 lbs 1 mkp	5/16 Inch 8 mm	1/2 Inch 12.7 mm	2 3/8 Inch 60 mm	\$146.00

OSDC-131-5/16x3/4

6 lbs  
1 mkp

5/16 Inch  
8 mm

3/4 Inch  
19.1 mm

2 3/8 Inch  
60 mm

\$146.00

---

Showing 10 of 656