



15 SERIES SELECTION GUIDE

Suffix -1 and -2 refer to mounting configuration, see diagram below.

MODEL	DC OUTPUT CURRENT	INPUT	OUTPUT
13DV1A	2 Amps*	12/24 VAC	0-11/0-22 VDC
13DV2A	2 Amps*	12/24 VAC	0-11/0-22 VDC
13DVE	3 Amps	12/24 VAC	0-11/0-22 VDC
15DV1A	2 Amps*	120/240 VAC	0-90/0-180 VDC
15DV2A	2 Amps*	120/240 VAC	0-90/0-180 VDC
15DVP	2 Amps	120/240 VAC	0-90/0-180 VDC
15DVE	3 Amps	120/240 VAC	0-90/0-180 VDC

* Rating for D.C. Output Current can be increased from 2.0 to 4.0 amps w/suitable external heatsink (equiv. to 4" x 4" x .125" aluminum plate).

OPERATING CONDITIONS

Temperature..... -10° to +45° C.
 AC Input Voltage ±10% Rated Line Voltage
 Input Frequency 50/60 Hz.

ELECTRICAL SPECIFICATIONS AC INPUT 50/60 HZ

MAXIMUM MODEL	MAX. CONTINUOUS AC AMPS	CONTINUOUS ARM AMPS*	MAX HP
<i>12 VAC Single Phase Input, 0-11 VDC Output</i>			
13DVA	2.6	2.0	1/40
13DVE	3.9	3.0	1/25
<i>24 VAC Single Phase Input, 0-22 VDC Output</i>			
13DVA	2.6	2.0	1/20
13DVE	3.9	3.0	1/12
<i>120 VAC Single Phase Input, 0-90 VDC Output</i>			
15DVA/15DVP	2.6	2.0	1/6
15DVE	3.9	3.0	1/3
<i>240 VAC Single Phase Input, 0-180 VDC Output</i>			
15DVA/15DVP	2.6	2.0	1/3
15DVE	3.9	3.0	2/3

* Minimum Armature Amps: 150mA D.C.

HOOK-UP DIAGRAM

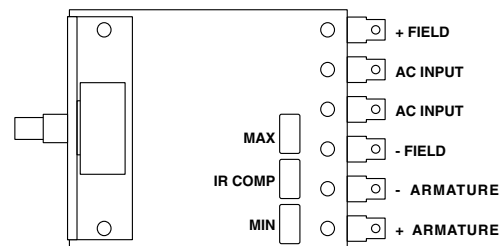

HEATSINK DIMENSIONS AND STYLES

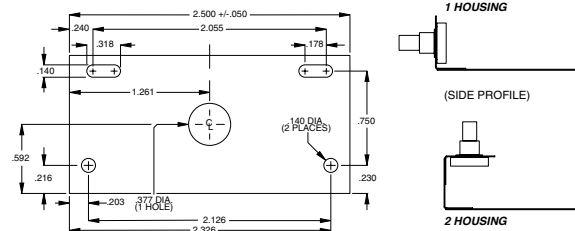

OPTION DESCRIPTION

OPTION	SUFFIX
Single pole AC switch integral with speedpot for 120 VAC application of -1 mounting style only	-104
3-position terminal strip with speedpot, dial, & knob kit	-TS

15 Series Adjustable Speed DC Control

The 15 Series is a general purpose, economical variable speed control for small DC and universal motor applications featuring: **dual input voltages of 12/24 VAC or 120/240 VAC** with a DC output current rating of 2 Amps, adjustable trimpot settings, and quick connect terminal pins. **The 15 Series is available in two compact panel mount styles; a NEMA 1 (15DVP) and NEMA 4 (15DVE) enclosed model.**

15 SERIES STANDARD FEATURES

- Dual voltage models of 12/24 VAC or 120/240 VAC input
- Full wave bridge power supply
- Adjustable Minimum speed (0-30% of max)
- Adjustable Maximum speed (40-145% of base)
- Adjustable IR Compensation
- Fixed Acceleration (0.5 seconds)
- 5K ohm speed potentiometer with leads, knob & dial included
- 25:1 speed range • 1% speed regulation
- Shunt field supply provided (1 Amp max)
 - 10V for 12 VAC; 20V for 24 VAC input,
 - 100V for 120 VAC; 200V for 240 VAC input
- Overload capacity of 200% for 1 minute
- Transient voltage protection
- Power on/off switch (enclosed models)
- AC line fuse (15DVE only)

DIMENSIONAL SPECIFICATIONS

MODEL	WIDTH	HEIGHT	DEPTH	WEIGHT
English (metric)				
13DV1A/15DV1A	2.80 (7.20)	1.30 (3.30)	3.30 (8.40)	2.64 oz. (75 gm)
13DV2A/15DV2A	2.80 (7.20)	1.50 (3.30)	3.30 (8.40)	2.94 oz. (83 gm)
13DVE/15DVE	3.81 (9.68)	5.50 (13.96)	3.50 (8.89)	20.30 oz. (576 gm)
15DVP	4.173 (10.60)	4.96 (12.60)	1.75 (4.45)	16.30 oz. (462 gm)