

Inductive Rectangular Sensors

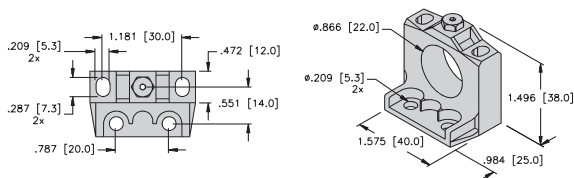

Housing Style - Rectangular	Part Number	ID Number	Features	Embeddable	Sensing Range (mm)	Output
CA40 - Embeddable, eurofast® Connector 	Bi20U-CA40-AN6X2-H1141 W/BS2.1	M1627390	<i>Uprox</i>	•	20	3-Wire DC NPN
	Bi20U-CA40-AP6X2-H1141 W/BS2.1	M1627290	<i>Uprox</i>	•	20	
	Bi20U-CA40-AP6X2-H1141/S1590 W/BS2.0	M1627297	<i>weldguard®</i>	•	20	
	Bi20U-CA40-AP6X2-H1141/S1591 W/BS2.0	M1627296	<i>armorguard®</i>	•	20	
	Bi20U-CA40-AP6X2-H1141/S1591 W/BS2.1	M1627294	<i>armorguard</i>	•	20	
CA40 - Embeddable, minifast® Connector 	Bi20U-CA40-ADZ30X2-B1131 W/BS2.1	M4283290	<i>Uprox</i>	•	20	2-Wire AC/DC Short-Circuit Protected
	Bi20U-CA40-ADZ30X2-B1131/S1669	M4283205	<i>Stoneface®</i>	•	20	
	Bi20-CA40-ADZ30X2-B1131/S34/S1590	M4283593	<i>weldguard</i>	•	20	
	Bi20-CA40-ADZ30X2-B1131/S34/S1591 W/BS2.1	M4283595	<i>armorguard</i>	•	20	
CA40 - Embeddable, microfast® Connector 	Bi20U-CA40-ADZ30X2-B3131 W/BS2.1	M4283292	<i>Uprox</i>	•	20	2-Wire AC/DC Short-Circuit Protected
	Bi20-CA40-ADZ30X2-B3131/S34 W/BS2.1	M4283590		•	20	
	Bi20-CA40-ADZ30X2-B3131/S34/S1590	M4283594	<i>weldguard</i>	•	20	
	Bi20-CA40-ADZ30X2-B3131/S34/S1591 W/BS2.1	M4283596	<i>armorguard</i>	•	20	

Note: 1. BS2.1 is the standard mounting bracket for CA40 unless noted differently.



BS 2.1 Mounting Bracket

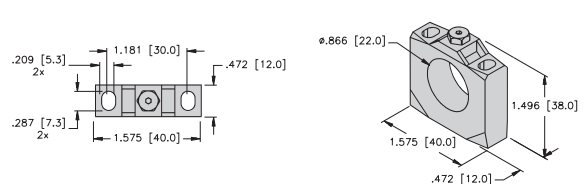

BS 2.0 Mounting Bracket

For detailed sensor specifications see Section M.
Normally Closed versions available upon request, consult factory.



Voltage	Switching Freq. (Hz)	Operating Current (mA)	Operating Temp. (°C)	Protection	Housing	Front Cap/Face	Power LED	Output LED	Mating Cord/ Cable Length/Jacket	Wiring Diagram #	Wiring Diagrams
10-30 VDC	250	≤200	-30 to +85	IP 67	AL	TP	GN	YE	RK 4T-*	1	<p>Diagram 1</p>
10-30 VDC	250	≤200	-30 to +85	IP 67	AL	TP	GN	YE	RK 4T-*	2	<p>Diagram 2</p>
	250	≤200	-30 to +85	IP 67	AL	WG	GN	YE	RK 4T-*	2	
	250	≤200	-30 to +85	IP 67	AG	WG	GN	YE	RK 4T-*	2	
	250	≤200	-30 to +85	IP 67	AG	WG	GN	YE	RK 4T-*	2	
10-300 VDC 20-250 VAC	20	≤400/300	-30 to +85	IP 67	AL	TP	GN	YE	RKM 30-*M	3	<p>Diagram 3</p>
	20	≤400/300	-30 to +85	IP 67	AL	SF	GN	YE	RKM 30-*M	3	
	20	≤400/300	-25 to +70	IP 67	AL	WG	GN	YE	RKM 30-*M	3	
	20	≤400/300	-25 to +70	IP 67	AG	WG	GN	YE	RKM 30-*M	3	
10-300 VDC 20-250 VAC	20	≤400/300	-30 to +85	IP 67	AL	TP	GN	YE	KB 3T-*	4	<p>Diagram 4</p>
	20	≤400/300	-25 to +70	IP 67	AL	TP	GN	YE	KB 3T-*	4	
	20	≤400/300	-25 to +70	IP 67	AL	WG	GN	YE	KB 3T-*	4	
	20	≤400/300	-25 to +70	IP 67	AG	WG	GN	YE	KB 3T-*	4	

Rectangular

For material descriptions see page M36.